

Sam<sup>l</sup> Hews

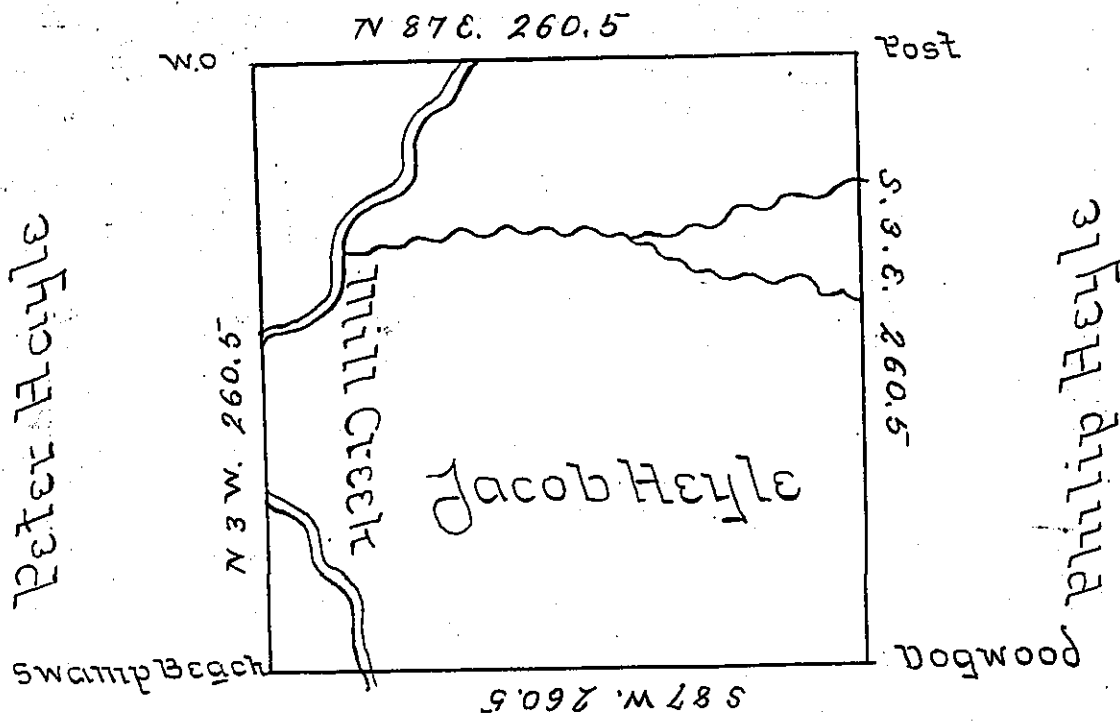

Godfrey Heyle

Situate on the Waters of Beaver Creek in District  
 No 3 Allegany County Containing 400<sup>ac</sup> 16<sup>ps</sup> and  
 Allowance Surveyed the 27<sup>th</sup> May 1705 in Pursu-  
 -ance of a Warrant granted Jacob Heyle 21<sup>st</sup> April  
 1704

Ben. Stokesly D.S.

Don<sup>l</sup> Brodhead Esq. Sg.

New in Mercer County

*IN TESTIMONY* that the above is a copy of the original remaining on file in  
 the Department of Internal Affairs of Pennsylvania, made  
 conformably to an Act of Assembly approved the 16th day of  
 February, 1833, I have hereunto set my Hand and caused  
 the Seal of said Department to be affixed at Harrisburg,  
 this twenty eighth day of February 1905.

*Leach R. Brown*  
 Secretary of Internal Affairs.